

+NOTICE!!

These documents have been scanned!

Do not place un-scanned documents beneath this notice!

Do not remove this notice from this file!

GPO Jacket No. 560-102
Print Order 61549
Rise Business Services, LLC
Job=AZ15 1/8/2020



Box Number= AZ15283



Claim Begin-End: AMC457991-AMC457992

1 Initial Receipt



AZ15283-36

AMC458525-AMC458783

United States Department of the Interior
Bureau of Land Management
 DIV OF LANDS, MINRLS & ENERGY
 ONE N CENTRAL AVE
 PHOENIX, AZ 85004 -4427
 Phone: 602-417-9200

Receipt	
No:	4589315

Transaction #: 4711017
Date of Transaction: 10/22/2019
CUSTOMER:
NOAH GORDON PO BOX 800 CONGRESS,AZ 85332-0800 US

LINE #	QTY	DESCRIPTION	REMARKS	UNIT PRICE	TOTAL
1	2.00	LOCATABLE MINERALS / MINING CLAIMS-NEW,UNADJUD, ONE OR MORE AUTH NOS / NEW MINING CLAIM PROCESSING FEE CASES: AMC457991/\$20.00, AMC457992/\$20.00		- n/a -	40.00
2	2.00	LOCATABLE MINERALS / MINING CLAIMS-NEW,UNADJUD, ONE OR MORE AUTH NOS / NEW MINING CLAIMS LOCATION FEE CASES: AMC457991/\$40.00, AMC457992/\$40.00		- n/a -	80.00
3	2.00	LOCATABLE MINERALS / MINING CLAIMS-NEW,UNADJUD, ONE OR MORE AUTH NOS / NEW MINING CLAIMS MAINTENANCE FEE CASES: AMC457991/\$165.00, AMC457992/\$165.00		- n/a -	330.00
TOTAL:					\$450.00

PAYMENT INFORMATION			
1	AMOUNT:	450.00	POSTMARKED: N/A
	TYPE:	CHECK	RECEIVED: 10/22/2019
	CHECK NO:	246	
	NAME:	GORDON, NOAH PO BOX 800 CONGRESS AZ 85332-0800 US	

REMARKS

ENTERED
 NOV 08 2019
 BY: R Am

This receipt was generated by the automated BLM Collections and Billing System and is a paper representation of a portion of the official electronic record contained therein.

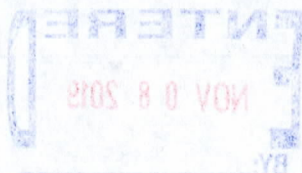

NOTICE!!

These documents have been scanned!

Do not place un-scanned documents beneath this notice!

Do not remove this notice from this file!

GPO Jacket No. 560-102
Print Order 61549
Rise Business Services, LLC
Job=AZ15 1/8/2020



Box Number= AZ15283



Claim Begin-End: AMC457991-AMC457992

2 Correspondence



AZ15283-36

AMC458525-AMC458783

**NO
DOCUMENTS
FOUND**

NO DOCUMENTS FOUND
NO DOCUMENTS FOUND

NOTICE!!

These documents have been scanned!

Do not place un-scanned documents beneath this notice!

Do not remove this notice from this file!

GPO Jacket No. 560-102
Print Order 61549
Rise Business Services, LLC
Job=AZ15 1/8/2020



Box Number= AZ15283



Claim Begin-End: AMC457991-AMC457992

3 Transfers



AZ15283-36

AMC458525-AMC458783

**NO
DOCUMENTS
FOUND**

NO DOCUMENTS FOUND
NO DOCUMENTS FOUND

NOTICE!!

These documents have been scanned!

Do not place un-scanned documents beneath this notice!

Do not remove this notice from this file!

GPO Jacket No. 560-102
Print Order 61549
Rise Business Services, LLC
Job=AZ15 1/8/2020



Box Number= AZ15283



Claim Begin-End: AMC457991-AMC457992

4 Annual Filings



AZ15283-36

AMC458525-AMC458783

DEPARTMENT OF THE INTERIOR
BUREAU OF LAND MANAGEMENT
MINING CLAIMS

Run Date/Time: 9/24/2020

MC Maintenance Fees Paid Through the BLM Pay Portal
(by Date Paid)

Page 1 Of 1

CBS Receipt: 4770819

Printed For Lead File # AMC457991

Agency Tracking ID: 1595944807

Assessment Year: 2021

Number of BLM Serial Nr: 1

Paid On: 7/28/2020

Total Amount Paid:\$165.00

Message: :

Claim Name	BLM Serial No	Lead File No	Amount Paid
REBEL	AMC457992	AMC457991	\$165.00

United States Department of the Interior
Bureau of Land Management
 BUSINESS & SUPPORT SVCS DIV
 ONE N CENTRAL AVE SUITE 800
 PHOENIX, AZ 85004 -4427
 Phone: 602-417-9200

Receipt	
No:	4770819

Transaction #: 4897632	
Date of Transaction: 07/28/2020	
CUSTOMER:	
	JAMES D SLAY 13960 SEAL BEACH,CA 90740 US

LINE #	QTY	DESCRIPTION	REMARKS	UNIT PRICE	TOTAL
1	1.00	LOCATABLE MINERALS / MINING CLAIMS- NOT NEW-UNADJUD,ONE AUTH NO. ONLY / MINING CLAIM MONEY RECEIVED CASES: AMC457992/\$165.00		- n/a -	165.00
TOTAL:					\$165.00

PAYMENT INFORMATION			
NOTE: Items will appear on credit card statement as "BLM O Mining Claim".			
1	AMOUNT:	165.00	POSTMARKED: N/A
	TYPE:	CREDIT CARD	RECEIVED: 07/28/2020
	NAME:	JAMES D SLAY 13960 SEAL BEACH CA 90740 US	
	CARD NO:	XXXXXXXXXXXX0193	AUTH CODE: BHQW4C
	NAME ON CARD:	JAMES D SLAY	
	SIGNATURE:	INTERNET	

REMARKS

This receipt was generated by the automated BLM Collections and Billing System and is a paper representation of a portion of the official electronic record contained therein.

**NO
DOCUMENTS
FOUND**

NO DOCUMENTS FOUND
NO DOCUMENTS FOUND

NOTICE!!

These documents have been scanned!

Do not place un-scanned documents beneath this notice!

Do not remove this notice from this file!

GPO Jacket No. 560-102
Print Order 61549
Rise Business Services, LLC
Job=AZ15 1/8/2020



Box Number= AZ15283



Claim Begin-End: AMC457991-AMC457992

5 Miscellaneous

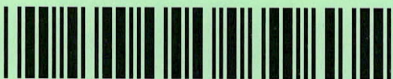

AZ15283-36

AMC458525-AMC458783

TO: UNITED STATES DEPARTMENT OF THE INTERIOR
BUREAU OF LAND MANAGEMENT
ONE N. CENTRAL AVE SUITE 800
PHOENIX, AZ, 85004-4427

October 15th, 2019

Dear Bureau of Land Management,

Please record the (2) following Notice of Mining Locations. A check for \$450 for the fees is enclosed.

Sincerely,

Noah Gordon

Enclosed:
Notification letter
2 Notice of Mining Locations
Location fees totaling \$450.

RECEIVED
BLM AZ STAFF OFFICE
2019 OCT 18 P 2:31
PHOENIX, ARIZONA

NOTICE!!

These documents have been scanned!

Do not place un-scanned documents beneath this notice!

Do not remove this notice from this file!

GPO Jacket No. 560-102
Print Order 61549
Rise Business Services, LLC
Job=AZ15 1/8/2020



Box Number= AZ15283



Claim Begin-End: AMC457991-AMC457992

6 Location Notices-Amendments and Supporting Documents



AZ15283-36

AMC458525-AMC458783

MINING CLAIM STATUS REPORT – Assessment Year 2020

Data Entered: 10/8/19 Ram

MTP Checked By: 10/8/19 Ram
 GEO Checked By: 10/8/19 Ram

LEAD SERIAL NUMBER: AMC 457991 thru AMC 457992

NUMBER OF CLAIMS & TYPE:

2 LODE
 PLACER
 ASSOCIATION PLACER
 MILL SITE
 TUNNEL SITE

CHARGES:

Processing Fee @ \$20 = \$ 40
 Location Fee @ \$40 = \$ 80
 Maintenance Fee @ \$165 = \$ 330
 Add'l Maint Fee for Assoc Placer = \$
SUBTOTAL \$
 Other Fees \$
 Other Fees \$
TOTAL \$ 450

TOTAL ACREAGE: Per Claim
 (Placer Only)

NUMBER OF LOCATORS:

DOCUMENTS RECEIVED VIA : Over-the-Counter [] Mail **TIMELY FILED:** Yes No []

LEGAL DESCRIPTION: T 8N R 5W SEC 15
 T R SEC
 T R SEC
 T R SEC
 T R SEC

BLM [] FOREST SERVICE [] SUBJ TO PL 359: Yes [] No []
 WILDERNESS AREA []

SPLIT ESTATE: N/A [] SX [] PX [] OTHER []
 SRHA [] Was proper Notice filed if located on SHRA Land? Yes [] No []

RECONVEYED MINERALS ON BLM LAND REQUIRE OPENING ORDER FROM 1944 TO 1993:

Open to Entry On N/A []

COMMENTS/STATUS: VOID [] PARTIALLY VOID [] PVT MINERALS [] WITHDRAWN LANDS []
 OTHER []

[] Claimant acknowledges that portions of the following claim(s) site(s) may be void or voidable.

Printed Name of Claimant Signature of Claimant

*****FINAL ADJUDICATION*****

DATE INITIALS

AMC 457991

Noah Gordon
P.O. Box 800
Congress, AZ, 85332

LOCATION NOTICE FOR PLACER MINING CLAIM

Amendment BLM Serial # _____

NOTICE IS HEREBY GIVEN that the Goldenrod
_____ placer mining claim has been located by
Noah Gordon whose current mailing
address is P.O. Box 800, Congress, AZ, 85332

RECEIVED BLM AZ STATE OFFICE 2019 OCT 18 P 2:31 PHOENIX, ARIZONA	BLM Date Stamp
---------------------------------------------------------------------------	----------------------

The general course of this claim is Rectangular E-W and it is situated in Yavapai
County, Arizona. This claim is 1320' feet in length and 660' feet in width.

20 Total Claim Acreage. This claim runs from the location monument on which this location notice is
posted at the NE corner of the claim approximately 1320' feet in a Westerly direction to the
West end line and 660' feet in a Southerly direction to the South end line. This claim is
marked by four monuments, one at each corner of the claim.

The location monument on which this notice is posted is situated within Section 15, Township
8 N, Range 5 W, Gila Salt River Base and Meridian, Arizona. This claim encompasses
portions of the following legal subdivision(s) if located by legal subdivision or the following quarter section(s),
section(s), Township(s) and Range(s) S1/2 SW1/4 SW1/4 SEC.15 T8NR5W, GSRB&M, AZ
_____, Gila Salt River Base and Meridian, Arizona.

The locality of this claim with reference to some natural object or permanent monument and additional information
(if any) concerning its locality are as follows: The SW corner of the claim is 0' North of the
SW corner of Section 15, T8N R5W, GSRB&M, AZ

_____ The above information is shown on the attached map.

DATED AND POSTED on the ground this 13TH day of OCTOBER, 20 19

LOCATOR(s) AGENT

Print Name(s) Noah Gordon

Signature(s) _____

Form MCF102
Revised July 2014

This form is available from the Arizona Geological Survey and may be reproduced.

AMC457991

MINING CLAIM MAP

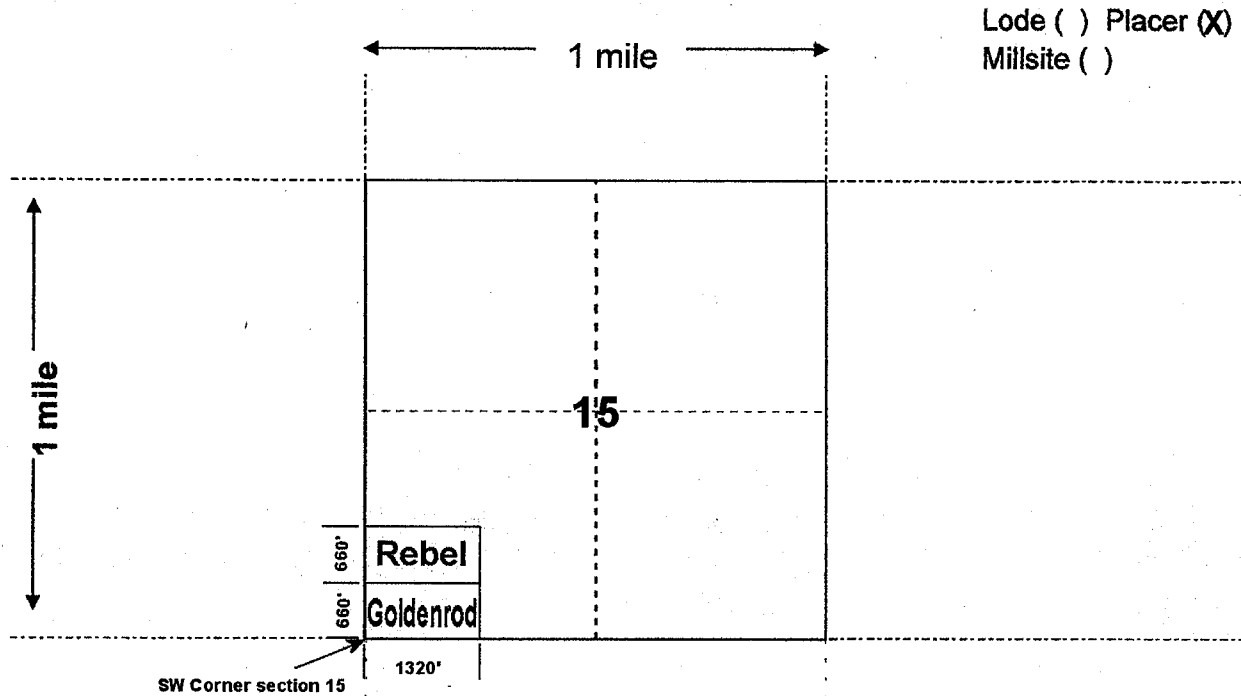

all corners are 90 degrees unless specified.

Scale: 1" = 2000 feet



1. The above map depicts the Goldenrod mining claim, which is located in Section (s) 15, Township 8 N, Range 5 W, Gila and Salt River Base and Meridian, YAVAPAI County, Arizona. Total claim acreage is 20

2. The type of corner and location monuments used are as follows: 2"X5' Tall PVC pipe with aluminum name tag.

3. The bearings and distances in degrees and feet between claim corners and to a public land survey monument are as depicted on the map.

4. If the claim is a placer or millsite claim with exterior limits conforming to legal subdivisions of the public survey, provide a legal description of the claim S1/2 SW1/4 SW1/4 SEC.15 T8NR5W, GSRB&M, AZ

Form MCF100a
Revised July 2014

This form is available from the Arizona Geology Survey and may be reproduced.

Noah Gordon
P.O. Box 800
Congress, AZ, 85332

LOCATION NOTICE FOR PLACER MINING CLAIM

Amendment BLM Serial # _____

NOTICE IS HEREBY GIVEN that the Rebel
_____ placer mining claim has been located by
Noah Gordon whose current mailing
address is P.O. Box 800, Congress, AZ, 85332

BLM
Date
Stamp

RECEIVED
BLM AZ STATE OFFICE
2019 OCT 18 P 2:31
PHOENIX, ARIZONA

The general course of this claim is Rectangular E-W and it is situated in Yavapai
County, Arizona. This claim is 1320' feet in length and 660' feet in width.

20 Total Claim Acreage. This claim runs from the location monument on which this location notice is
posted at the SE corner of the claim approximately 1320' feet in a Westerly direction to the
West end line and 660' feet in a Northerly direction to the North end line. This claim is
marked by four monuments, one at each corner of the claim.

The location monument on which this notice is posted is situated within Section 15, Township
8 N, Range 5 W, Gila Salt River Base and Meridian, Arizona. This claim encompasses
portions of the following legal subdivision(s) if located by legal subdivision or the following quarter section(s),
section(s), Township(s) and Range(s) N1/2 SW1/4 SW1/4 SEC.15 T8NR5W, GSRB&M, AZ
_____, Gila Salt River Base and Meridian, Arizona.

The locality of this claim with reference to some natural object or permanent monument and additional information
(if any) concerning its locality are as follows: The SW corner of the claim is 660' North of the
SW corner of Section 15, T8N R5W, GSRB&M, AZ

_____ The above information is shown on the attached map.

DATED AND POSTED on the ground this 13TH day of OCTOBER, 2019

LOCATOR(s) AGENT

Print Name(s) Noah Gordon

Signature(s) 

Form MCF102
Revised July 2014

This form is available from the Arizona Geological Survey and may be reproduced.

AMC457992

MINING CLAIM MAP

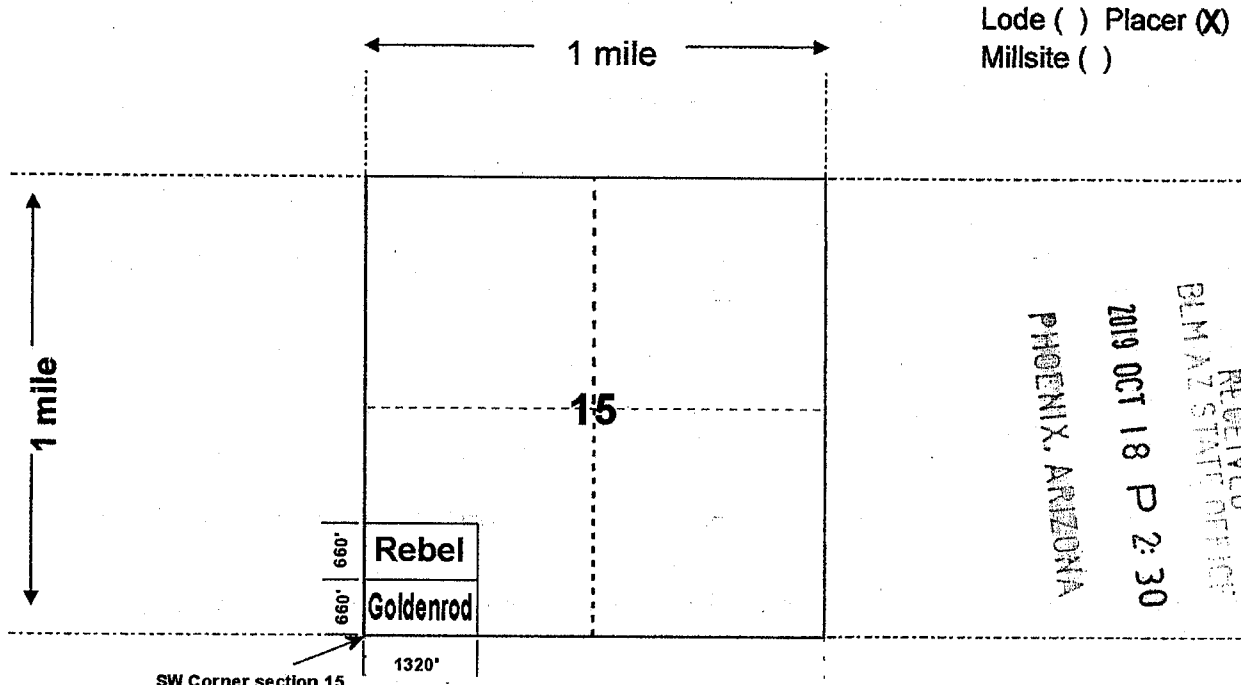

SW Corner section 15

all corners are 90 degrees unless specified.

Scale: 1" = 2000 feet



1. The above map depicts the Rebel mining claim, which is located in Section (s) 15, Township 8 N, Range 5 W, Gila and Salt River Base and Meridian, YAVAPAI County, Arizona. Total claim acreage is 20
2. The type of corner and location monuments used are as follows: 2"X5' Tall PVC pipe with aluminum name tag.
3. The bearings and distances in degrees and feet between claim corners and to a public land survey monument are as depicted on the map.
4. If the claim is a placer or millsite claim with exterior limits conforming to legal subdivisions of the public survey, provide a legal description of the claim N1/2 SW1/4 SW1/4 SEC.15 T8NR5W, GSRB&M, AZ

Form MCF100a
Revised July 2014

This form is available from the Arizona Geology Survey and may be reproduced.

Date and Time Run:
11/8/2019 10:42:11 AM

Page 1 of 1

DEPARTMENT OF THE INTERIOR
BUREAU OF LAND MANAGEMENT
Case Recordation

Geographic Report with Land

Disposition is equal to **AUTHORIZED , CANCELLED , EXPIRED , PENDING , REJECTED , RELINQUISHED ,
WITHDRAWN**
and Meridian Township Range Section is equal to **14 0080N 0050W 015**
and Admin State is equal to **AZ**

NO WARRANTY IS MADE BY BLM
FOR USE OF THE DATA FOR
PURPOSES NOT INTENDED BY BLM

DEPARTMENT OF THE INTERIOR
BUREAU OF LAND MANAGEMENT
Case Recordation
Geographic Report with Land

Admin State: AZ
Geo State: AZ

Serial Number	Total Case Acres:	Casetype	Case Disp	Mer	Twp	Rng	Sec	Sur Type	Sur Nr	Suf	Subdivision	Act Pend
AZA 018699	0.500	281007	AUTHORIZED	14	0080N	0050W	015	FF		1	EAST 33' OF N2SWNW;	
AZA 023855	10.000	271000	AUTHORIZED					MNR		1	NENENW;	
AZA 023858	40.000	272000	AUTHORIZED					ALIQ			NWNW;	
AZA 031469	9.930	281001	AUTHORIZED					ALIQ			NWNE,E2NW,NWSW;	
AZA 032543	0.190	281001	AUTHORIZED					MNR			N2NWSW;	
AZA 037396	1.000	380913	PENDING					FF			SW;	
AZAR 0000110	39.400	285003	AUTHORIZED					ALIQ			E2;	

NOAH GORDON
P.O. Box 800
CONGRESS, AZ

85332

RECEIVED
BLM AZ STATE OFF

2019 OCT 18 P 2:31

PHOENIX, ARIZONA

PHOENIX AZ 852

25 OCT 2019 PM 11 2



BUREAU OF LAND MANAGEMENT
ONE N. CENTRAL AVE. SUITE #800
PHOENIX, AZ
85004-4427

85004-442700

